

KIP-AIR[®]

CODICE FAMIGLIA
FAMILY CODE

100

DISPOSITIVO DI COMANDO PROPORZIONALE AIR PROPORTIONAL CAB SWITCH

SERIE
SERIES

KIP-AIR[®]

Codice foglio: 997-100-00161 Rev: AF



Dispositivo di comando pneumatico proporzionale a cloche, con funzioni integrate per azionamento PTO e controllo salita / discesa del ribaltabile. Disponibile in diverse versioni per soddisfare ogni esigenza.

Air proportional cab switch with full integrated lever to control both PTO engagement and body tipping / lowering.
Several versions available to meet any requirements.

Rev:

Codice fascicolo: //

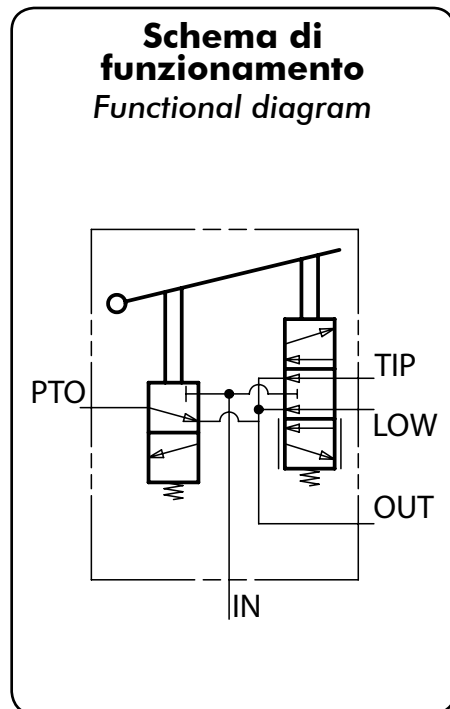
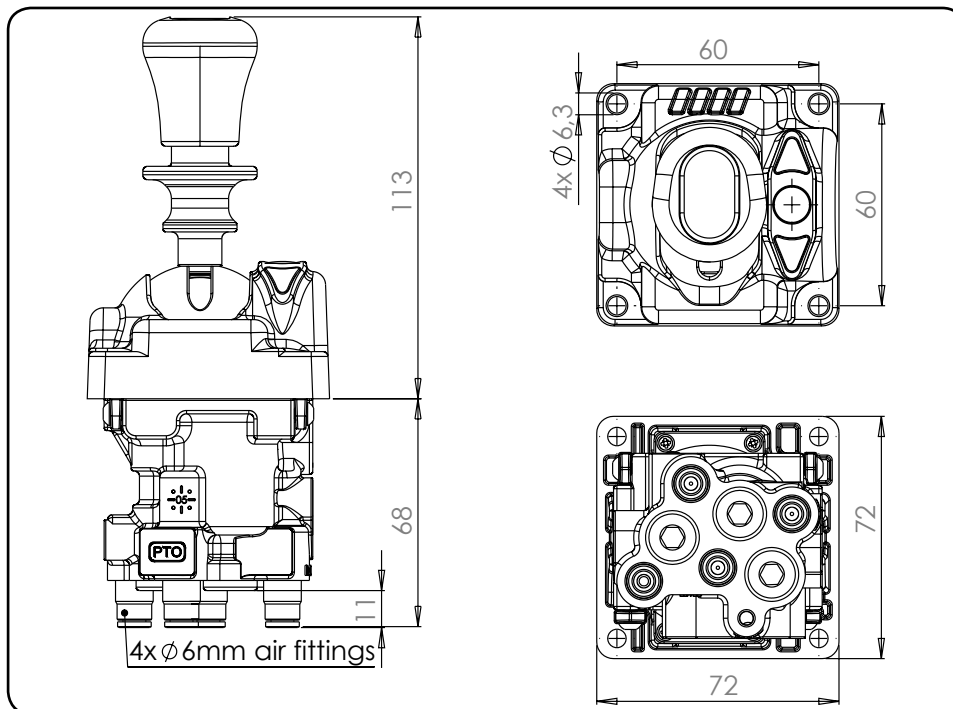

Data: Martedì 31 gennaio 2006

PER DISPOSITIVI DI COMANDO CODICE / FOR PRODUCTS CODE:

Versioni disponibili: Available versions:		Discesa con PTO... - Lowering keeping the PTO...		
		Disinserita disengaged	Inserita engaged	Senza comando PTO Without PTO control
Ritorno cloche Lever return	Automatico Automatic "CE"	100-001-61003	100-001-61030	100-001-61110
	Manuale Manual (con blocco salita/discesa) (with low and tip block)	100-001-61094	100-001-61067	100-001-61101

pag.1



O.M.F.B. S.p.A. Hydraulic Components
We reserve the right to make any changes without notice.
Edition 2004.11 No reproduction, however partial, is permitted.
Via Cave, 7/9 25050 Provatigla d'Iseo (Brescia) Italy Tel.: +39.030.9830611
Fax: +39.030.9839207-208 Internet: www.omfb.it e-mail: info@omfb.it

COMPANY
WITH QUALITY SYSTEM
CERTIFIED BY DNV
ISO 9001/2000

100-002-60030:Supporto OPTIONAL.
 Accessorio per il fissaggio esterno del kip-air
 altezza 50mm.

100-002-60030:Bracket (OPTIONAL).
 Mounting tower for KIP-AIR H=50mm.

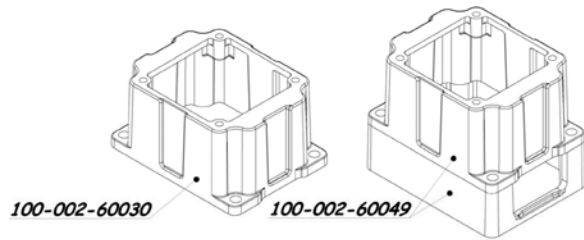

100-002-60049:Supporto OPTIONAL.
 Accessorio per il fissaggio esterno del kip-air
 altezza 80mm.

100-002-60049:Bracket (OPTIONAL).
 Mounting tower for KIP-AIR H=80mm.

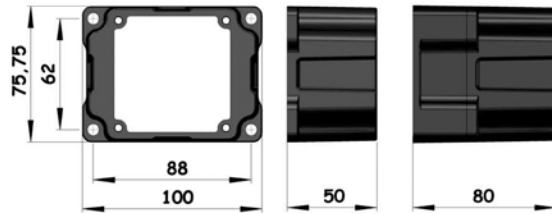

100-002-60067:Supporto OPTIONAL per il
 fissaggio esterno del kip-air. Con questo kit c'è la
 possibilità di alloggiare un selettore pneumatico
 (optional) per il comando di applicazioni
 ausiliarie.

100-002-60067:Bracket for KIP-AIR mounting
 (OPTIONAL). With this kit you can also fit a pneumatic
 switch (OPTIONAL) to control other auxiliary
 applications.

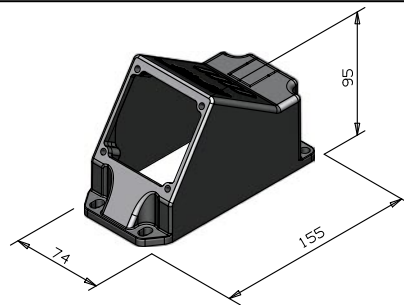

100-002-60094:Staffa multiposizione per
 montaggio KIP-AIR.

100-002-60067:Multi-positions bracket for KIP-AIR.

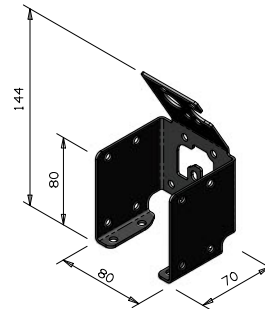

100-002-60076: Kit staffa quadra fissaggio
 a cruscotto completa di viti di fissaggio KIP-AIR
 (OPTIONAL).

100-002-60076: Flange and screws for fixing
 the switch on the dashboard (OPTIONAL).

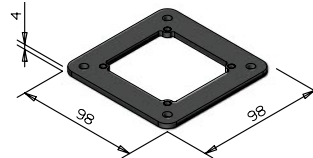

100-002-60101:Selettore OPTIONAL a 2 vie
 pneumatico da utilizzarsi con il supporto 100-
 002-60067.

2-ways pneumatic selector to be coupled with our
 bracket P/N 100.002.60067 (optional).

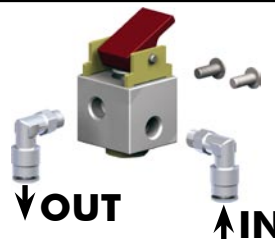

100-002-00032:Kit segnalatore elettrico di
 pressione OPTIONAL.

Pressure signal switch assembly P/N 100.002.00032
 (optional).

