

# Zugösen • Towing eyes • Anneaux de remorquage • Occhioni di traino • Puntas de lanza 40 mm / 50 mm

- D** Form A mit Schweißende
- GB** Shape A for welding
- F** Forme A avec extrémité soudée
- I** Forma A con estremità saldata
- E** Forma A con extremo soldado

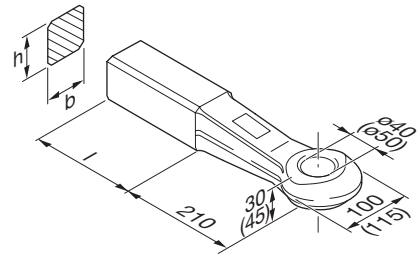

## Technische Daten • Technical data • Données technique • Dati tecnici • Datos técnicos

	ø (mm)	h x b (mm)	l (mm)	<b>R</b> <b>C</b>		<b>S</b> <b>V</b>		(kg)	<b>e1</b>
				<b>D</b> (kN)	<b>Dc</b> (kN)	<b>S</b> (kg)	<b>V</b> (kN)		
57260	40	40 x 40	110	18	18	180	8	4,1	00-0739
57262	40	50 x 40	110	25	25	250	9	4,7	00-0740
57264	40	50 x 50	110	70	50	500	14	5,9	00-0741
57268	40	65 x 55	125	125	66	900	20	7,8	00-0743
57270	40	65 x 60	125	125	74	1000	23	8,2	00-0744
57272	50	65 x 60	170	130	90	1000	30	11,4	00-0625

Form A mit Schweißende nur für Schweizer Kupplungen • Shape A for welding only for Swiss hitches • Forme A avec extrémité soudée uniquement pour crochets suisses • Forma A con estremità saldata solo per ganci svizzeri • Forma A con extremo soldado sólo para enganches suizos

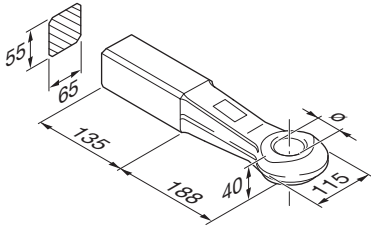

	ø (mm)	<b>D</b> <b>Dc</b>		<b>S</b> <b>V'</b>		(kg)	<b>e1</b>
		<b>D</b> (kN)	<b>Dc</b> (kN)	<b>S</b> (kg)	<b>V'</b> (kN)		
57229	40	125	66	900	20,0	8,7	00-0694
57229	40	168	66	900	20,0	8,7	00-0694

Form B mit Schraubende • Shape B for bolting • Forme B avec extrémité vissée • Forma B con estremità a vite • Forma B con extremo atornillado

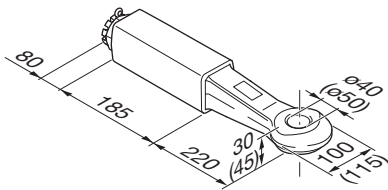

	ø (mm)	<b>D</b> <b>Dc</b>		<b>S</b> <b>V'</b>		(kg)	<b>e1</b>
		<b>D</b> (kN)	<b>Dc</b> (kN)	<b>S</b> (kg)	<b>V'</b> (kN)		
57252	40	125	74	1000	23,0	11,0	00-0691
57254	50	130	90	1000	25,0	12,6	00-0627

Form C/D mit Flansch • Shape C/D with flange • Forme C/D avec platine • Forma C/D con flangia • Forma C/D con brida

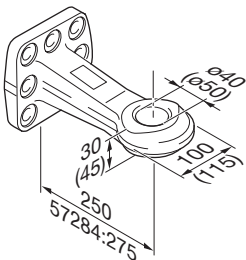

	ø (mm)	<b>D</b> <b>Dc</b>		<b>S</b> <b>V'</b>		(kg)	<b>e1</b>
		<b>D</b> (kN)	<b>Dc</b> (kN)	<b>S</b> (kg)	<b>V'</b> (kN)		
57243	40	130	100	1000	35,8	8,8	00-0046
57349	40	130	100	1000	35,8	8,8	00-0046
57244	50	190	135	1000	72,5	9,5	00-0045
57244	50	190	113	2500	43,2	9,5	00-0045
57284	50	250	135	1000	90,0	17,9	00-0162
57284	50	250	113	3000	43,2	17,9	00-0162

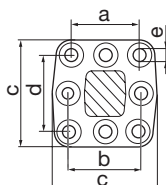



	<b>a</b> (mm)	<b>b</b> (mm)	<b>c</b> (mm)	<b>d</b> (mm)	<b>e</b> (mm)
57243	100±0,5	110±0,5	ca. 154	110±0,5	17,0
57349	100±0,5	110±0,5	ca. 154	110±0,5	17,0
57244	100±0,5	110±0,5	ca. 154	110±0,5	17,0
57284	130±0,3	130±0,3	190+4	130±0,3	21,0

# Zugösen • Towing eyes • Anneaux de remorquage • Occhioni di traino • Puntas de lanza

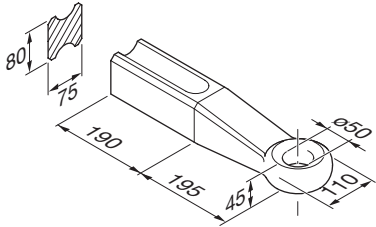

Schwerlastzugösen mit Schweißende 50 mm • Heavy duty towing eyes for welding 50 mm • Anneaux de remorquage pour lourdes charges avec extrémité soudée 50 mm • Occhioni per traini eccezionali con estremità saldata 50 mm • Puntas de lanza para cargas pesadas con extremo soldado 50 mm

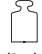

	 <b>D (kN)</b>	<b>S (kg)</b>	 <b>R (t)</b>	 <b>(kg)</b>
57005	314		250	13,4

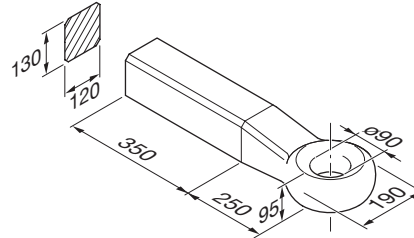

mit Schweißende 90 mm • for welding 90 mm • avec extrémité soudée 90 mm • con estremità saldata 90 mm • con extremo soldado 90 mm



	<b>S (kg)</b>	 <b>R (t)</b>	 <b>(kg)</b>
57121		1000	82

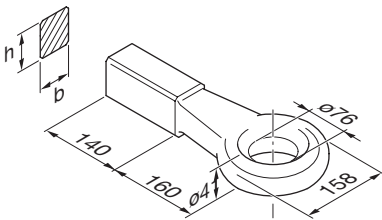

Ringzugösen mit Schweißende 76 mm • Ring towing eyes for welding 76 mm • Anneaux de remorquage avec extrémité soudée 76 mm • Occhioni torici con estremità saldata 76 mm • Puntas de lanza anulares con extremo soldado 76 mm



	<b>h x b (mm)</b>	 <b>D' (kN)</b>	<b>S (kg)</b>	 <b>C' (t)</b>	 <b>(kg)</b>
57006	60 x 65	120	1000	12	10,3

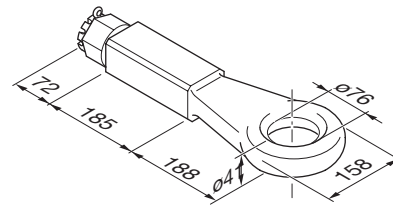

mit Schraubende 76 mm • for bol ting 76 mm • avec extrémité vissée 76 mm • con estremità a vite 76 mm • con extremo atornillado 76 mm



	 <b>D' (kN)</b>	<b>S (kg)</b>	 <b>C' (t)</b>	 <b>(kg)</b>
57294	120	1000	12	18,5
57295	200	1500	15	18,5

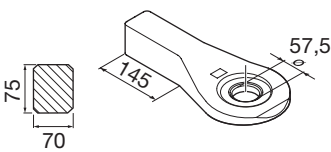

Zugösen 57,5 mm • Towing eyes 57,5 mm • Anneaux de remorquage de 57,5 mm • Occhioni di traino 57,5 mm • Puntas de lanza 57,5 mm



	 <b>D (kN)</b>	 <b>S (kg)</b>	<b>Pc (kN)</b>	 <b>(kg)</b>	<b>e1</b>
57371	200	1000	25	12,5	00-1355

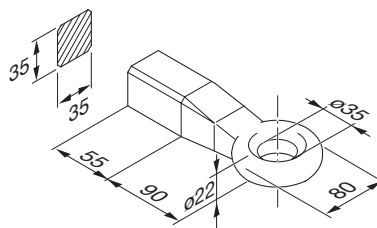



Zugösen für Flurförderzeuge mit Schweißende 35 mm • Towing eyes for industrial trucks for welding 35 mm • Anneaux de remorquage pour chariots de manutention avec extrémité soudée 35 mm • Occhioni per veicoli trasporti interni con estremità saldata 35 mm • Puntas de lanza para vehículos industriales con extremo soldado 35 mm

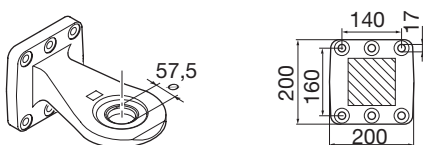

	 <b>R (t)</b>	<b>S (kg)</b>	 <b>(kg)</b>
57065	4		1,4

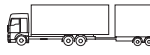
Zugösen 57,5 mm • Towing eyes 57,5 mm • Anneaux de remorquage de 57,5 mm • Occhioni di traino 57,5 mm • Puntas de lanza 57,5 mm

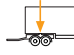

	 <b>D (kN)</b>	 <b>Dc (kN)</b>	 <b>S (kg)</b>	<b>V (kN)</b>	<b>Pc (kN)</b>	 <b>Av (t)</b>	 <b>(kg)</b>	<b>e1</b>
57370	300	131	1000	82	30	18	18,7	00-1356
57370	300	130	2000	50	30	18	18,7	00-1356
57370	300	146,5	1000	65,5	30	18	18,7	00-1356

# Zugösen • Towing eyes • Anneaux de remorquage • Occhio- nei di traino • Puntas de lanza 40 mm / 50 mm

Ersatzteile • Spare parts • Pièces de rechange • Ricambi • Piezas de recambio

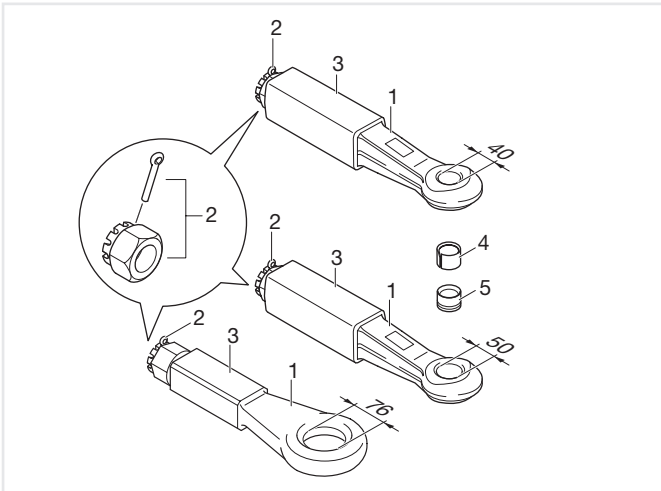

Pos.	ø (mm)	ROE	
01	40	57293	1
01	50	57292	1
01	76	57303	1
01	76	57304	1
02	40/50/76	56049	1
03	40/50/76	53435	1
04	40	53051	1
04	50	53004	1
05	40	53386	1
05	50	53376	1
05	90	53250	1

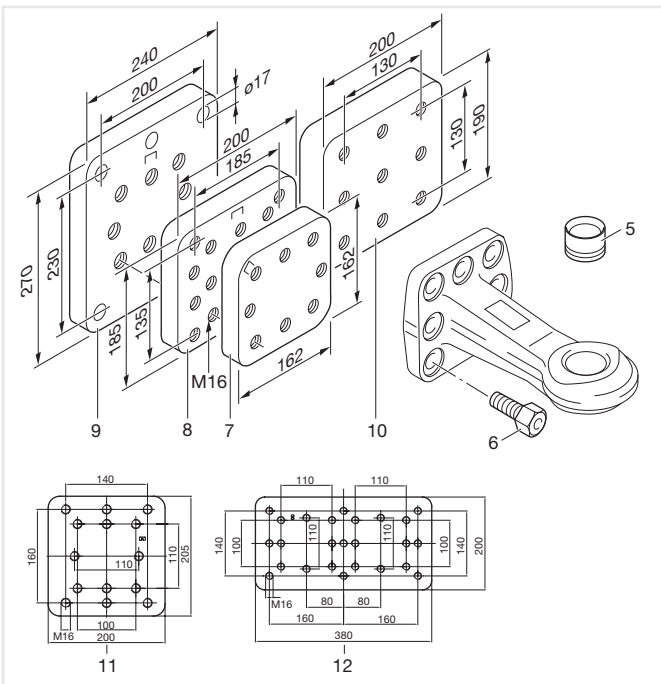

Pos.	ø (mm)	ROE	
05	40	53386	1
05	50	53376	1
05	57,5	53556	1
06	40	70951	1
06	40	70950	1
06	50	70950	1
06	50	70965	1
06	57,5	30414	1
07	40/50	70304	1
08	40/50	70305	1
09	40/50	70306	1
10	50	70307	1
11	50/57,5	59394	1
12	57,5	59395	1

## Übermaßbuchsen • Oversize bushes • Douilles à surmesure • Bussole maggiorate • Casquillos de sobremedida

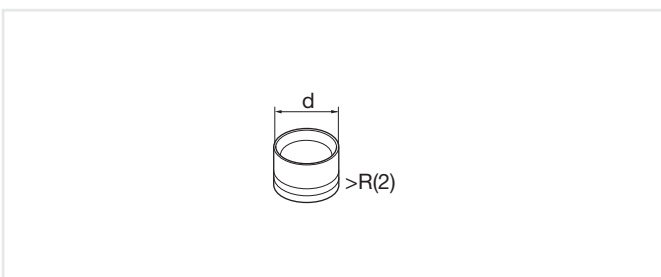

a = 40 mm

d (mm)	R	
48,5	1	53206
49,0	2	53207
49,5	3	53208
50,0	4	53209



a = 50 mm

d (mm)	R	
60,5	1	53362
61,0	2	53363